

Press Contact
Meaghan Ziemba
Content Marketing Manager
meaghan@ame.com
+1.608.346.5580

FOR IMMEDIATE RELEASE
Advanced Machine & Engineering
2500 Latham Street
Rockford, Illinois 61103
www.ame.com | +1.815.962.6076

More Manufacturing Jobs Expected with 2018 AME/Hennig Expansion

The expansion answers customer demand, creates new jobs, and brings manufacturing back to its prime in the United States

Rockford, Illinois, USA – November 30, 2017 – Advanced Machine & Engineering Co. (AME), www.ame.com, your one source solution for machine components, and its sister company, Hennig Inc., www.hennig-inc.com, a global leader in machine protection products and services, are preparing to expand by 2018.

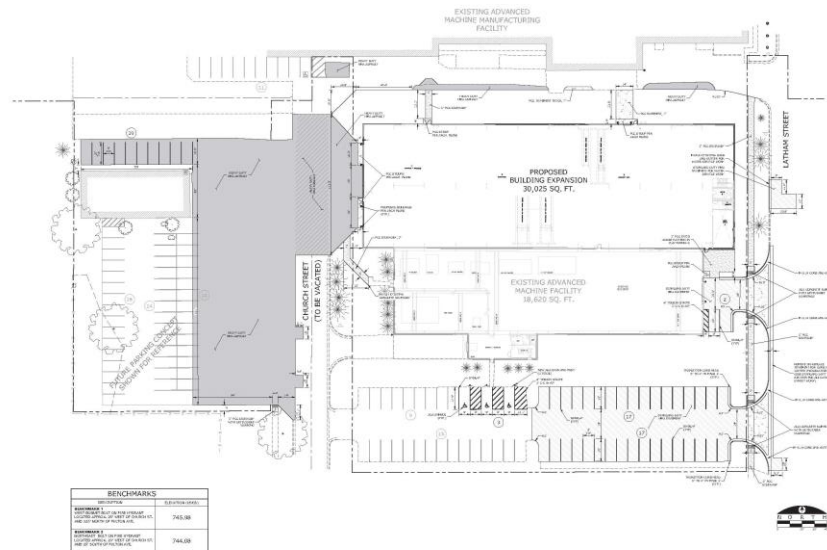

The expansion, expected to begin in November 2017, will involve three different facilities: both existing Hennig buildings in Machesney Park, Ill., and one at the AME facility in Rockford, Ill. Cord Construction (Rockford, Ill.), www.cordconstruction.com, will lead all development processes for all three sites.

"The expansion will not only increase our top line revenue and overall profitability, but more importantly, it will also allow us to grow our market share in our backup power generation business (Genset) that we started 10 years ago," explains Dietmar Goellner, AME/Hennig Inc. President & CEO. "We must increase capacity quickly to meet customer demand."

As for AME, the expansion will increase capacity for several of its product lines, including AMROK® (workholding products) and AMSAW® (sawing systems).

Press Contact
Meaghan Ziemba
Content Marketing Manager
meaghan@ame.com
+1.608.346.5580

FOR IMMEDIATE RELEASE
Advanced Machine & Engineering
2500 Latham Street
Rockford, Illinois 61103
www.ame.com / +1.815.962.6076

Both companies have invested heavily in new equipment to place in the new additions. Hennig acquired two large, state-of-the-art fiber laser cutting machines and a large press brake. AME invested in its second large Toyoda (Arlington Heights, Ill.), www.toyoda.com, horizontal machine center with complete automation for the continued manufacturing of workholding products.

"Within the next two years, we plan to add as many as 100 employees once the construction is complete -- 50 in Rockford and 50 in Machesney Park," says Goellner. "All three expansions are scheduled to be finished by June of next year (2018)."

While Goellner is excited for the benefits the expansion will bring to the local community; such as, additional business for their local suppliers, he is concerned about finding the proper skill sets in the 100 people needed to be hired.

"We at AME and Hennig consider ourselves to be manufacturing activists and we are bullish for the state of manufacturing in the United States," claims Goellner. "We're certainly doing our part to grow the manufacturing sector through our apprenticeship and other employee development programs. We passionately hope the United States manufacturing sector will again reach the glory days of the past."

About Advanced Machine & Engineering Co.

Advanced Machine & Engineering® (AME) was founded in 1966 out of Rockford, Illinois (USA) by Willy Goellner. Originally known as Advanced Engineering Co., AME has developed into a global leader in machine tool components and metal cutting machines for over 50 years. With strong core values supporting STEM (Science, Technology, Engineering, and Math) education, AME's robust apprenticeship and community outreach programs ensure a secure, innovative environment that supports AME facilities and the development of the American manufacturing movement.

About Hennig Inc.

Hennig Inc. has been designing and producing quality machine protection and chip/coolant management products since 1950 in Europe and worldwide. Our production and service centers span the globe, ensuring speedy dispatch of top class products and reliable support to our customers. We pride ourselves in utilizing the latest technologies available, and offer a quick turnaround and fast response to customers' varying needs.

Hennig's long standing reputation is a tribute to our dedicated engineering and production teams and technical know-how. Throughout our organization, hardworking people apply themselves to the creation of efficient, practical, and cost-effective solutions for customers all over the world. Making Our Customers Successful is not just our mission, it is a roadmap to improvement and growth.

###